

2011 Infiniti G Sedan

Quick Reference Guide

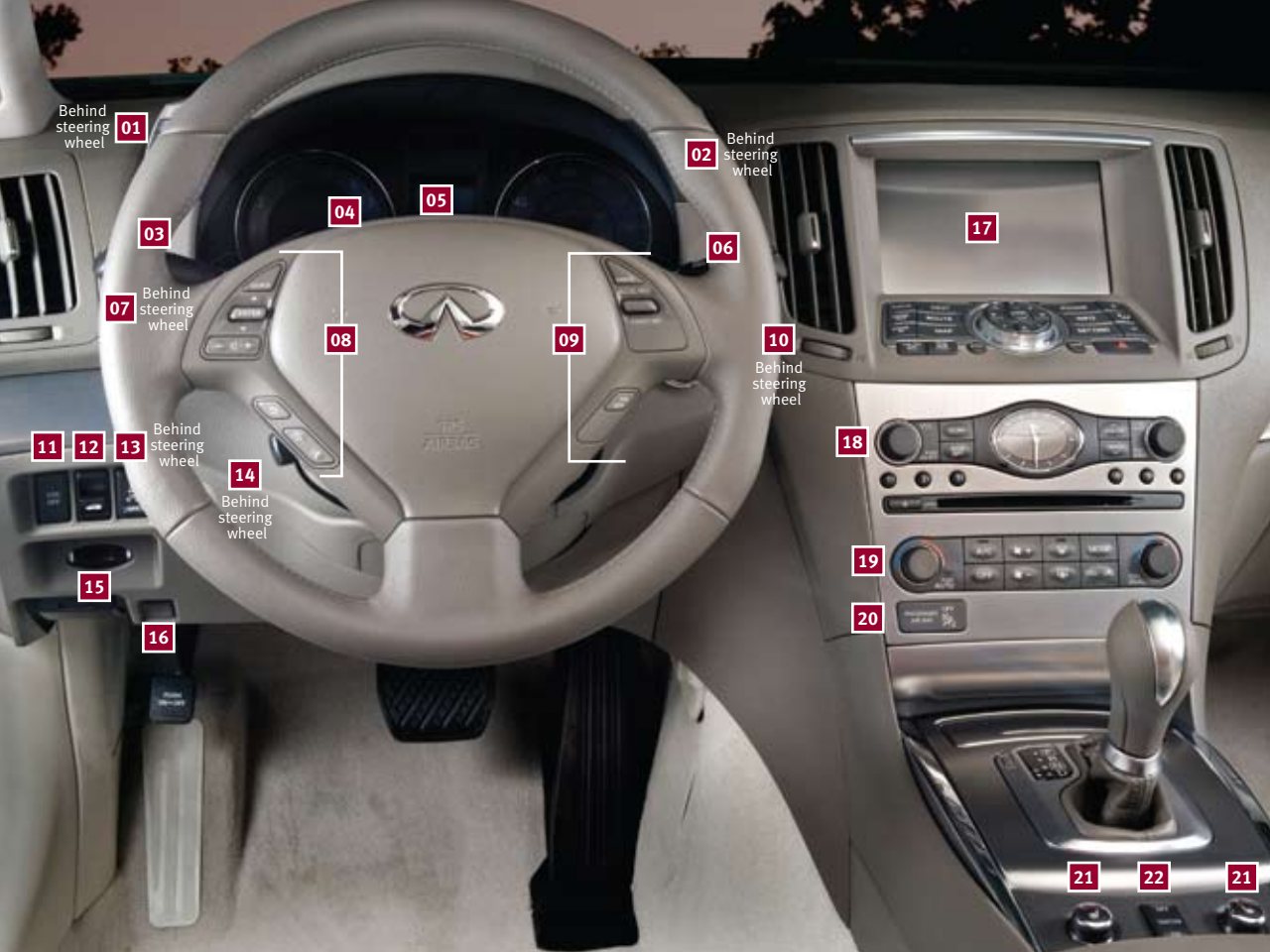

INFINITI.



01 Behind steering wheel

02 Behind steering wheel

03

04

05

06

17

07 Behind steering wheel

08

09

10 Behind steering wheel

11

12

13

Behind steering wheel

14

Behind steering wheel

15

16

18

19

20

21

22

21

- 01** INSTRUMENT BRIGHTNESS CONTROL*
- 02** TRIP COMPUTER SWITCHES*
- 03** HEADLIGHT AND TURN SIGNAL CONTROL
- 04** LOW TIRE PRESSURE WARNING LIGHT
- 05** VEHICLE INFORMATION DISPLAY*
- 06** WINDSHIELD WIPER / WASHER SWITCH
- 07** TRIP A/B RESET BUTTON*
- 08** STEERING WHEEL SWITCHES FOR AUDIO / BLUETOOTH®
- 09** CRUISE CONTROL
- 10** PUSH BUTTON IGNITION SWITCH*
- 11** VEHICLE DYNAMIC CONTROL (VDC) OFF SWITCH*
- 12** TRUNK RELEASE SWITCH
- 13** REAR SONAR SYSTEM SWITCH
- 14** TILT AND TELESCOPIC STEERING COLUMN*
- 15** INTELLIGENT KEY PORT
- 16** HOOD RELEASE*
- 17** CONTROL PANEL DISPLAY
- 18** AUDIO SYSTEM
- 19** AUTOMATIC CLIMATE CONTROL
- 20** FRONT PASSENGER AIR BAG STATUS LIGHT*
- 21** HEATED SEAT SWITCH*
- 22** SNOW MODE ON/OFF SWITCH*

*See your Owner's Manual for more information.

essential information

Loose Fuel Cap	2
Tire Pressure Monitoring System (TPMS)	2

first drive features

INFINITI Intelligent Key™ System	3
Power Seat Adjustments	3
Outside Mirror Control Switch	3
Starting/Stopping the Engine	4
Headlight Control Switch	4
Windshield Wiper Switch	5
Climate Controls	5
FM/AM/XM® Radio with CD/DVD Player (if so equipped)	6
Parking Brake	6
Trunk Lid Release	7
Fuel-Filler Door	7

system guide

Cruise Control	8
Bluetooth® Hands-free Phone System (if so equipped)	8
Navigation System (if so equipped)	8
HomeLink® Universal Transceiver (if so equipped)	9



- Always wear your seat belt.
- Supplemental air bags do not replace proper seat belt usage.
- Children 12 and under should always ride in the rear seat properly secured in child restraints or seat belts according to their age and weight.
- Do not drink and drive.

For more information, refer to the “**Safety — Seats, seat belts and supplemental restraint system (section 1)**” of your Owner’s Manual.



Additional information about your vehicle is also available in your Owner’s Manual, Navigation System Owner’s Manual and at www.InfinityUSA.com.

This easy-to-use Quick Reference Guide is intended to help you more fully appreciate some of the unique features and functions of your new vehicle. However, it is not intended to replace your Owner’s Manual. The Owner’s Manual contains more detailed information to help you better understand the important safety warnings, features, operation and maintenance of your vehicle. All information, specifications, photographs and illustrations in this publication are those in effect at the time of printing. INFINITI reserves the right to change specifications or design without notice and without obligation.

Loose Fuel Cap

- A LOOSE FUEL CAP warning message will appear in the dot matrix liquid crystal display **01** when the fuel-filler cap is not tightened correctly.
- The warning message will disappear when the vehicle detects the fuel-filler cap is properly tightened and the reset button **02** is pressed.
- If the cap is not properly tightened the Malfunction Indicator Light SERVICE ENGINE SOON may illuminate.

For more information, refer to the “**Instruments and controls (section 2)**” and the “**Pre-driving checks and adjustment (section 3)**” of your Owner’s Manual.

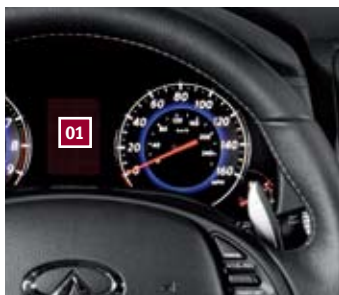

Tire Pressure Monitoring System (TPMS)

- A CHECK TIRE PRESSURE warning message will appear in the dot matrix liquid crystal display **01** and the TPMS light will illuminate when one or more tires are low on pressure and air is needed.
- After tire pressures are adjusted, drive the vehicle at speeds above 16 MPH (25km/h) and the warning and indicator light will disappear.
- When the low tire pressure warning light flashes for approximately 1 minute and then remains on, the TPMS is not functioning properly. Have the system checked by an INFINITI dealer.
- Tire pressure rises and falls depending on the heat caused by the vehicle’s operation and the outside temperature. Low outside temperature can lower the temperature of the air inside the tire, which can cause a lower tire inflation pressure. This may cause the low tire pressure warning light to illuminate. If the warning light illuminates in low ambient temperature, check the tire pressure in all four tires.

For more information, refer to the “**Instruments and controls (section 2)**” and the “**Starting and driving (section 5)**” of your Owner’s Manual.



INFINITI Intelligent Key™ System

The INFINITI Intelligent Key™ System allows you to lock or unlock your vehicle, open your trunk and start the engine.

- To lock or unlock the driver's or front passenger's door, push the door handle request switch **01** once.
- Push the door handle request switch **01** within 1 minute of unlocking the door and all other doors will unlock.

NOTE: It is important to make sure the Intelligent Key is with you (that is, in your pocket or purse).

For more information, refer to the "Pre-driving checks and adjustments (section 3)" of your Owner's Manual.



Power Seat Adjustments

- Push the control switch **01** forward or backward to slide the seat forward or backward.
- Push the switch **02** forward or backward to adjust the angle of the seatback.

SEAT LIFTER

- To adjust the angle and height of the seat cushion, push the front or rear end of the switch **01** up or down.

For more information, refer to the "Safety — Seats, seat belts and supplemental restraint system (section 1)" section of your Owner's Manual.



Outside Mirror Control Switch

- Turn the control switch **01** right or left to select the right or left side mirror.
- Move the control switch up, down, right or left to adjust the mirror angle.

For more information, refer to the "Pre-driving checks and adjustments (section 3)" of your Owner's Manual.



first drive features

Starting/Stopping the Engine

AUTOMATIC TRANSMISSION (if so equipped)

- Depress the brake pedal.
- Press the ignition switch **START/STOP** button to start the engine.

NOTE: It is important to make sure the INFINITI Intelligent Key™ is with you (that is, in your pocket or purse).

MANUAL TRANSMISSION (if so equipped)

- Depress the brake pedal.
- Move the shift lever to N (NEUTRAL).
- Depress the clutch pedal to the floor.
- Push the ignition switch **START/STOP** button.

TURNING THE ENGINE OFF

- For an automatic transmission, move the shift lever to the P (PARK) position, apply the parking brake and push the ignition switch.
- For a manual transmission, apply the foot brake, place the vehicle in first gear, apply the parking brake and push the ignition switch.

EMERGENCY ENGINE SHUT OFF

To shut off the engine in an emergency situation while driving, perform one of the following procedures:

- Rapidly push the push-button ignition switch 3 consecutive times, or
- Push and hold the push-button ignition switch for more than 2 seconds.

For more information, refer to the “**Starting and driving (section 5)**” of your Owner’s Manual.

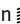

Headlight Control Switch

- Turn the headlight control switch **01** to the  position to turn on the front parking, side marker, tail, license plate and instrument lights.
- Turn the switch **01** to the position  to turn on the headlights.

For more information, refer to the “**Instruments and controls (section 2)**” of your Owner’s Manual.



Windshield Wiper Switch

- Move the lever to the following positions to operate the windshield wipers:

- 01** Mist (**MIST**) - One sweep operation of the wipers.
- 02** Auto (**AUTO**) – Operates the rain-sensing auto wiper system (if so equipped).
- 03** Low (**LO**) - Wipers operate at a continuous low-speed.
- 04** High (**HI**) - Wipers operate at a continuous high-speed.

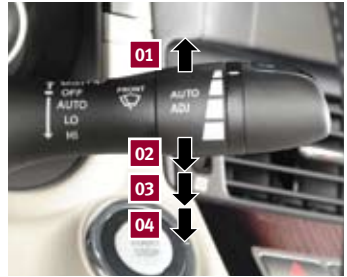

For more information, refer to the “**Instruments and controls (section 2)**” of your Owner’s Manual.

Climate Controls

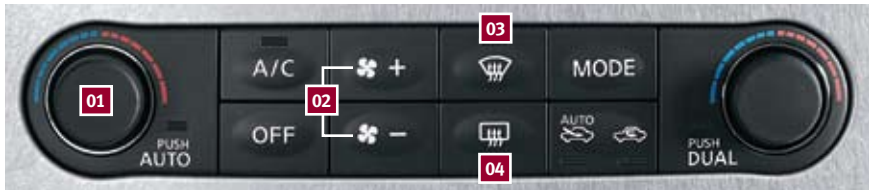

01 AUTO BUTTON/TEMPERATURE CONTROL KNOB

- Press the **AUTO** button to turn the system on and the fan speed, air flow distribution and temperature will be automatically maintained. Turn the driver’s side temperature control knob left for cooler air or right for warmer air.

02 FAN SPEED CONTROL BUTTONS

- Press the fan speed control buttons to manually adjust the fan speed up or down .

03 DEFROSTING/DEFOGGING FRONT AND SIDE WINDOWS

- Press the defroster control button to turn the system on or off.

04 DEFROSTING REAR WINDOW AND OUTSIDE MIRRORS (if so equipped)

- Push the rear window and outside mirror defroster switch to turn the system on or off.

For more information, refer to the “**Instrument and controls (section 2)**” or the “**Monitor, climate, audio, phone and voice recognition systems (section 4)**” of your Owner’s Manual.

first drive features

FM/AM/XM[®]* Radio With CD/DVD Player (if so equipped)



01 VOLUME CONTROL KNOB / ON•OFF BUTTON

- Press the VOLUME ON•OFF knob to turn the system on or off.
- Turn the VOLUME ON•OFF knob right or left to increase or decrease the volume.

02 TUNE/FOLDER/AUDIO CONTROL KNOB

- To manually tune the radio, turn the **TUNE/FOLDER/AUDIO** dial left or right.

*XM[®] Satellite Radio is only available on vehicles equipped with optional XM[®] satellite subscription service.

For more information, refer to the “**Monitor, climate, audio, phone and voice recognition systems (section 4)**” of your Owner’s Manual.

Parking Brake

WITH FOOT PEDAL (automatic transmission vehicles)

- To apply, firmly depress the parking brake pedal **01**.
- To release, firmly press the foot brake **02**, then press the parking brake pedal **01** and the parking brake will release.



WITH LEVER (manual transmission vehicles)

- To apply, pull the parking brake lever **03** up.
- To release, firmly press the foot brake while slightly pulling up on the parking brake lever. Push the button **04** and lower the lever completely.



For more information, refer to the “**Starting and driving (section 5)**” of your Owner’s Manual.

Trunk Lid Release

Use one of the following methods to open the trunk:

- Push the trunk open request switch **01** for more than one second while carrying the INFINITI Intelligent Key™ with you.
- Press the trunk button  **HOLD** on the Intelligent Key for more than one second.
- From inside the vehicle, push down on the trunk lid release switch **02** on the instrument panel.

For more information, refer to the “**Pre-driving checks and adjustments (section 3)**” of your Owner’s Manual.

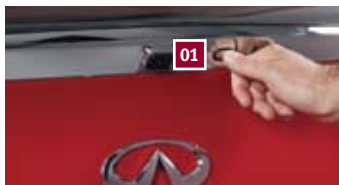

Fuel-Filler Door

The fuel-filler door is located on the right, rear side of the vehicle.

- When the doors of the vehicle are locked or unlocked, the fuel-filler door is automatically locked or unlocked at the same time.
- To open the fuel filler door, once unlocked, push the right side of the door.

For more information, refer to the “**Pre-driving checks and adjustments (section 3)**” of your Owner’s Manual.



system guide

Cruise Control

- The cruise control system enables you to set a constant cruising speed.
- The system will automatically maintain the set speed until you tap the brake pedal, accelerate, cancel or turn the system off.

For more information, refer to the **"Starting and driving (section 5)"** of your Owner's Manual.



Bluetooth® Hands-free Phone System (if so equipped)

- With an overhead microphone and sound transmitted through the audio system speakers, the Bluetooth® Hands-free Phone System utilizes Bluetooth wireless technology and voice recognition to provide hands-free cellular phone communication.

For more information, refer to the **"Monitor, climate, audio, phone and voice recognition systems (section 4)"** of your Owner's Manual or please visit www.InfinitiUSA.com/bluetooth.



Navigation System (if so equipped)



- Your Navigation System can calculate a route from the current location to a preferred destination. The real-time map display and turn-by-turn voice guidance will lead you along the route.
- The Navigation System will continually update your vehicle's position. If you have deviated from the original route, it will recalculate the route from your current location.
- The Navigation System can also provide you with important data, such as; distance to empty, your tire rotation schedule and other maintenance interval reminders.

For more information, please refer to your Navigation System Owner's Manual.

HomeLink® Universal Transceiver (if so equipped)



- The HomeLink® system can learn and consolidate the functions of up to three different hand-held transmitters, operating items such as; garage doors, property gates, outdoor and indoor lights or alarm systems.

For more information, refer to the **"Instruments and controls (section 2)"** of your Owner's Manual, the HomeLink® website www.homelink.com or call 1-800-355-3515.



INFINITI.

All illustrations, photographs and specifications in this guide are based on the latest product information; some vehicle parts cannot be shown in certain photographs. Some vehicles are shown with optional equipment. See actual vehicles for complete accuracy. Infiniti Division of Nissan North America, Inc. reserves the right to make changes at any time, without notice, in prices, colors, materials, equipment, specifications and models, and to discontinue models or equipment. Availability and delivery time for particular models and equipment combinations may vary. For information on availability, additional options or accessories, contact your Infiniti dealer. All specifications, options and accessories shown in this guide apply to the 49 continental states. Specifications, options and accessories may differ in Hawaii, U.S. territories and other countries. INFINITI, the Infiniti logo and INFINITI model names are Nissan trademarks.